

FLOOD MITIGATION AND PRAIRIE LOOP BOULEVARD (PLB)

Reach 1: Berm at 250m – **Constructed**,
Remaining Work for
summer 2015
– **Currently Underway**

Reach 2: PLB from
Morrison St. to Hardin St.
(Berm or Road TBD)
– **On Hold**

Reach 3, 4: PLB from
Hardin St. to McLeod St.
(PLB at 248.5 or 250 TBD)
– **On Hold**

Reach 5: PLB from McLeod St.
to Riedel St. (PLB at +/- 248.5)
– **Currently Underway**

Reach 6: PLB from Riedel St. to
Franklin Av. intersection
(PLB at 248.5 or 250 TBD) – **On Hold**

Snye Point Park – Currently Underway

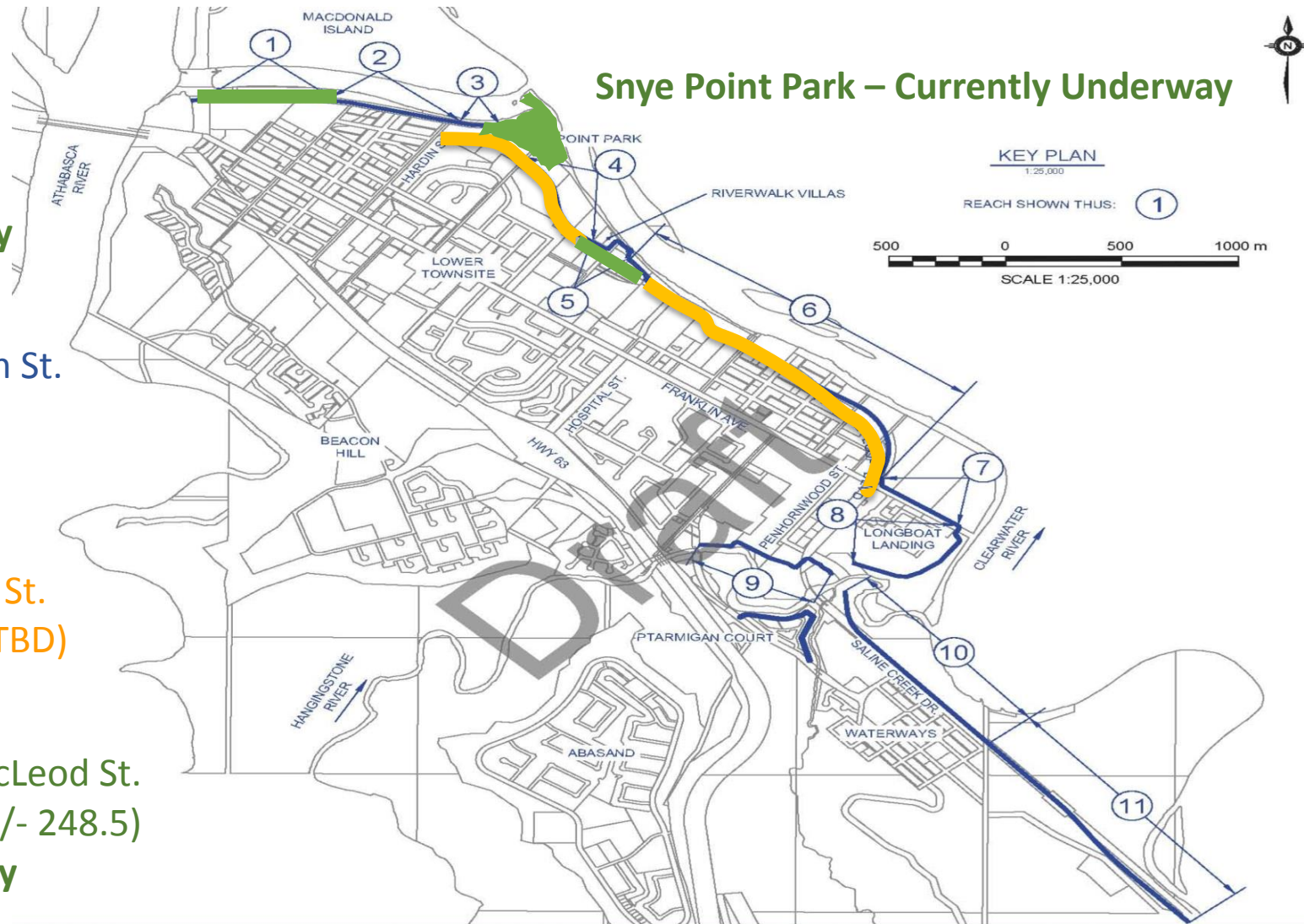

Reach 7, 8, 9, 10, 11:
Preliminary design work – **Completed**
Detailed Design (248.5 or 250 TBD) – **On Hold**